

Ground Floor

Approx. 26.7 sq. metres (287.8 sq. feet)



Total area: approx. 26.7 sq. metres (287.8 sq. feet)

Ground Floor

Approx. 26.7 sq. metres (287.8 sq. feet)

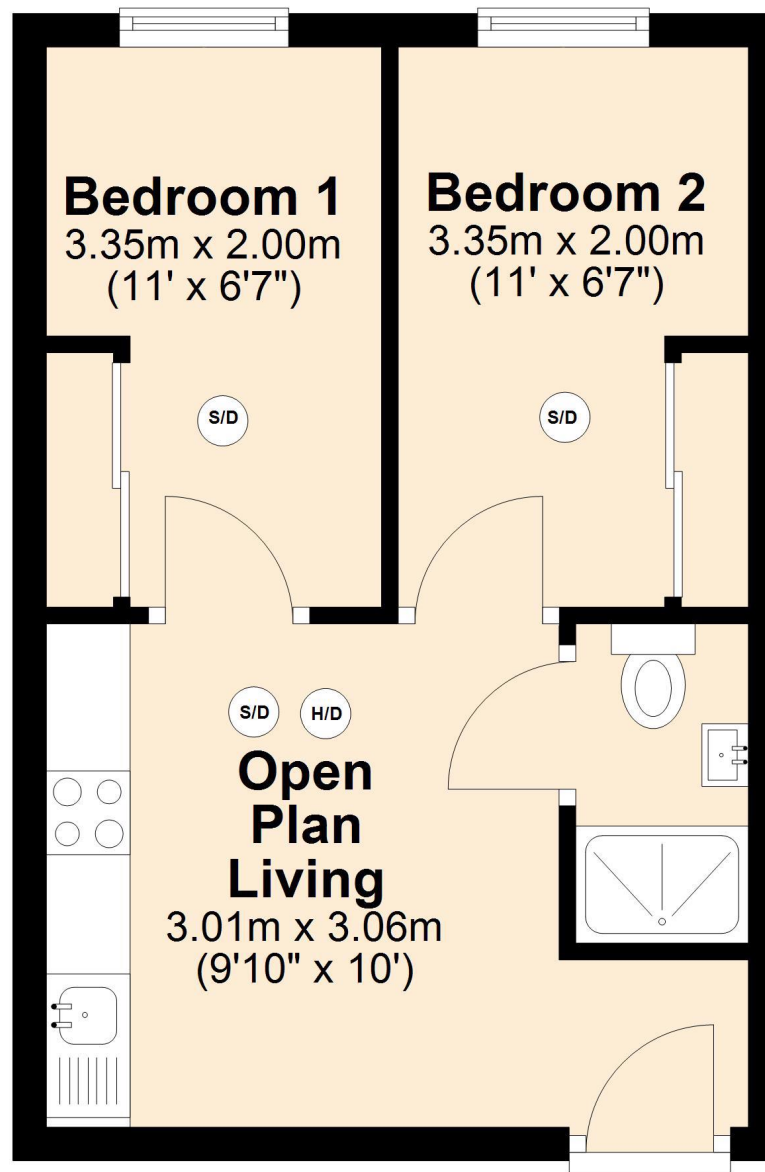

Total area: approx. 26.7 sq. metres (287.8 sq. feet)

306 Renwick Apartments