

Ground Floor

Approx. 36.2 sq. metres (389.2 sq. feet)

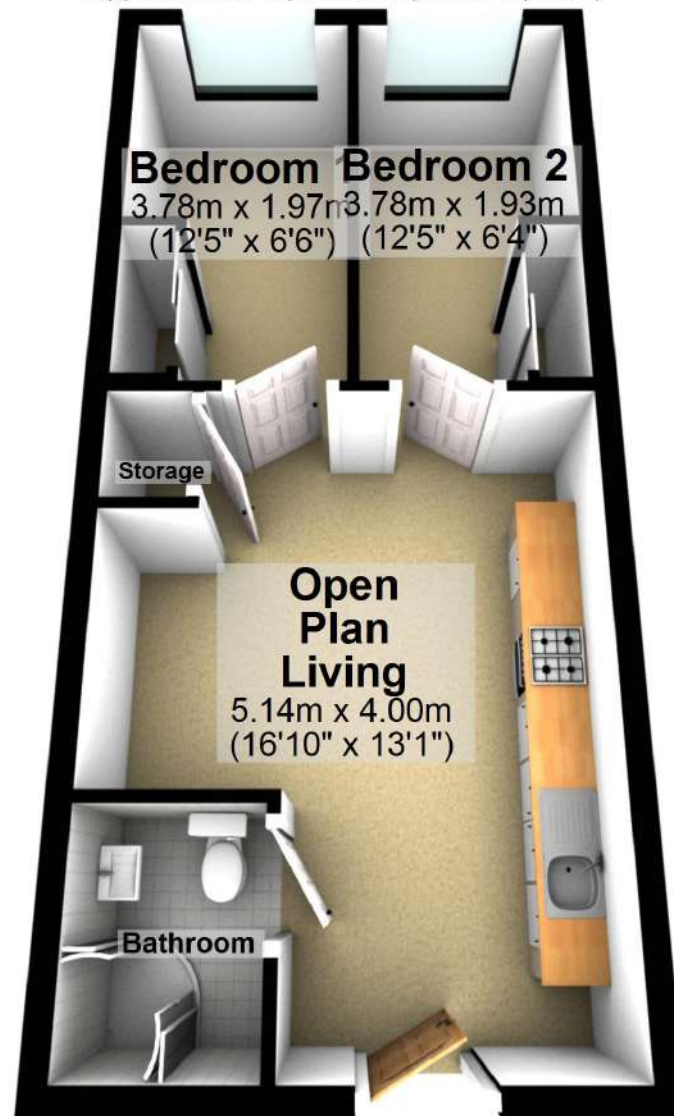

Total area: approx. 36.2 sq. metres (389.2 sq. feet)

Ground Floor

Approx. 36.2 sq. metres (389.2 sq. feet)

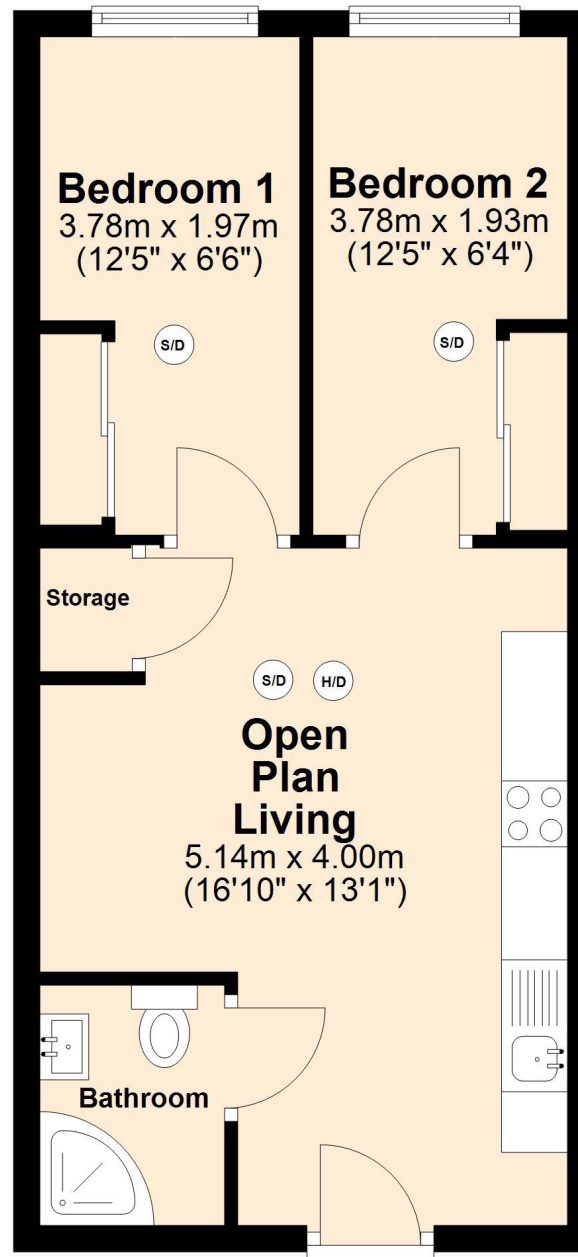

Total area: approx. 36.2 sq. metres (389.2 sq. feet)

305 Renwick Apartments