

## Ground Floor

Approx. 39.6 sq. metres (426.5 sq. feet)

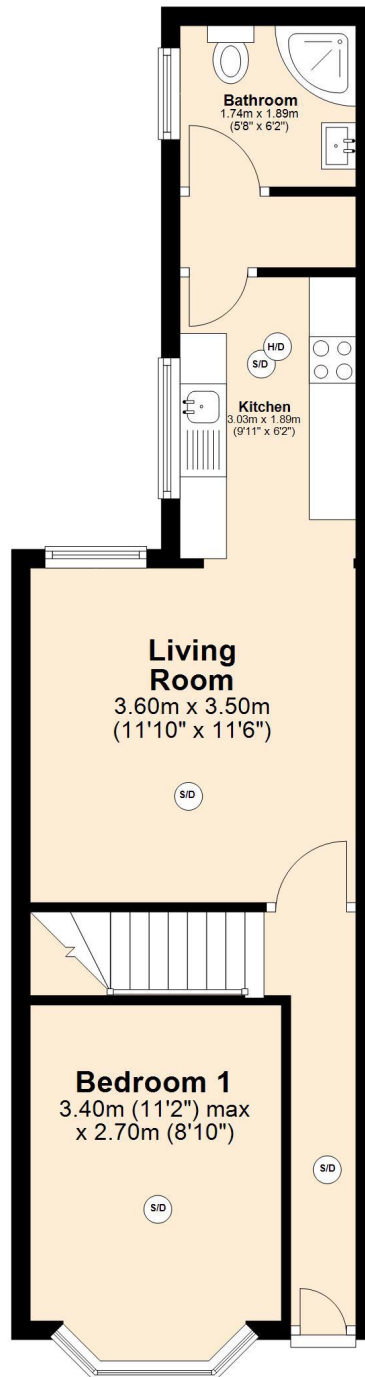

## First Floor

Approx. 32.9 sq. metres (354.3 sq. feet)

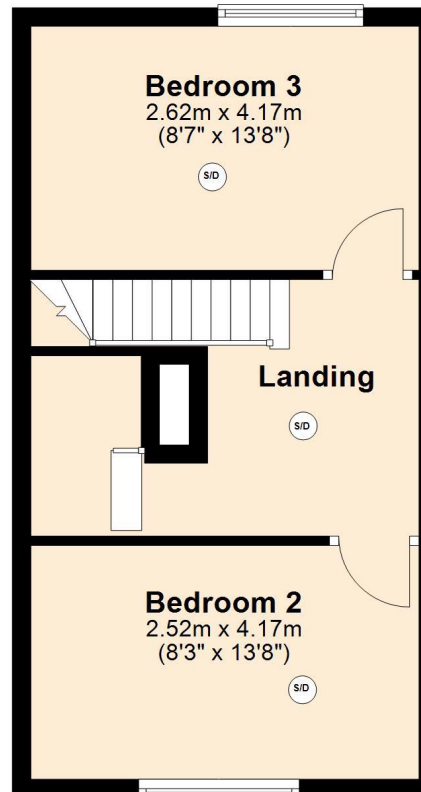

## Second Floor

Approx. 30.2 sq. metres (324.5 sq. feet)

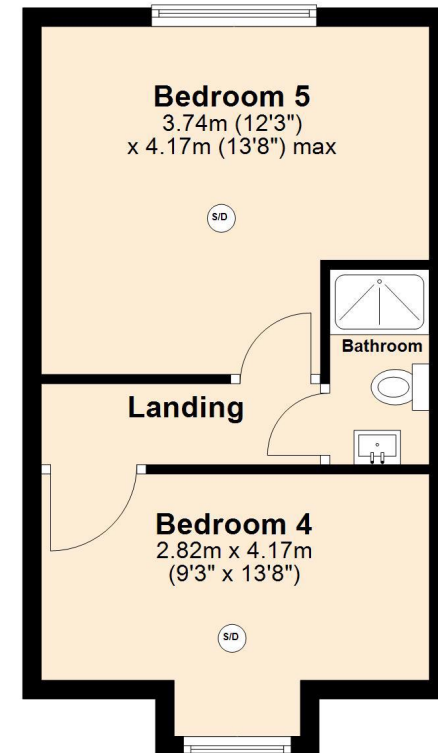

Total area: approx. 102.7 sq. metres (1105.3 sq. feet)

**32 Harrow Road**

## Ground Floor

Approx. 39.6 sq. metres (426.5 sq. feet)

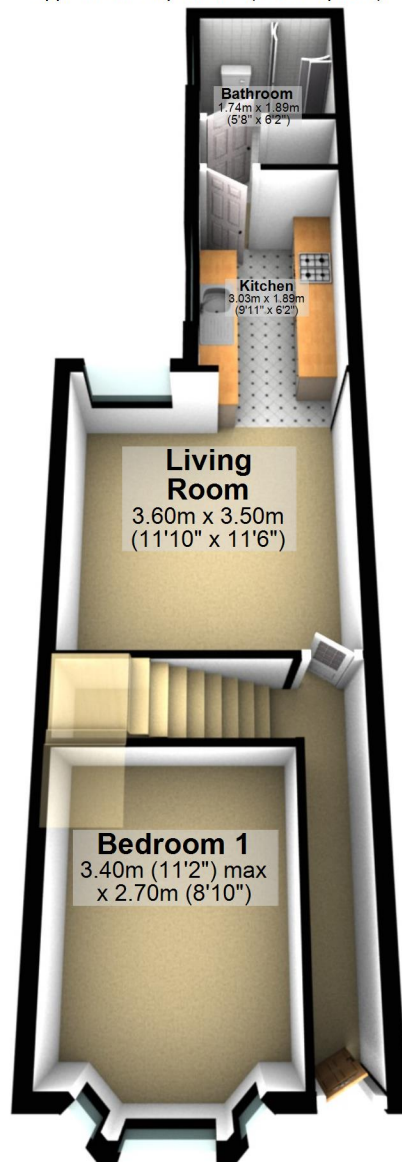

## First Floor

Approx. 32.9 sq. metres (354.3 sq. feet)

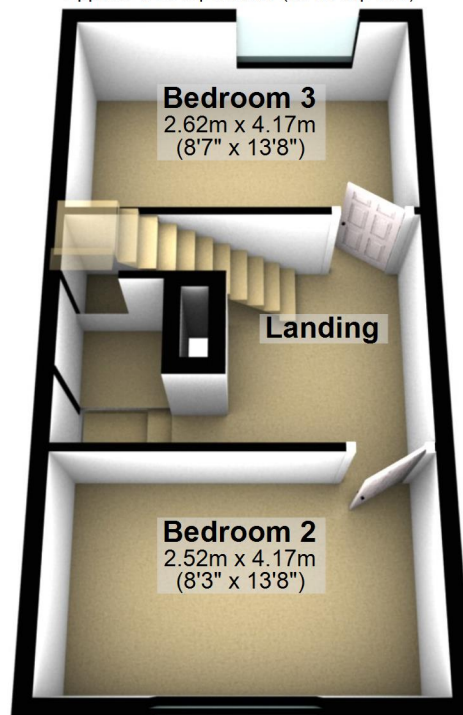

## Second Floor

Approx. 30.2 sq. metres (324.5 sq. feet)

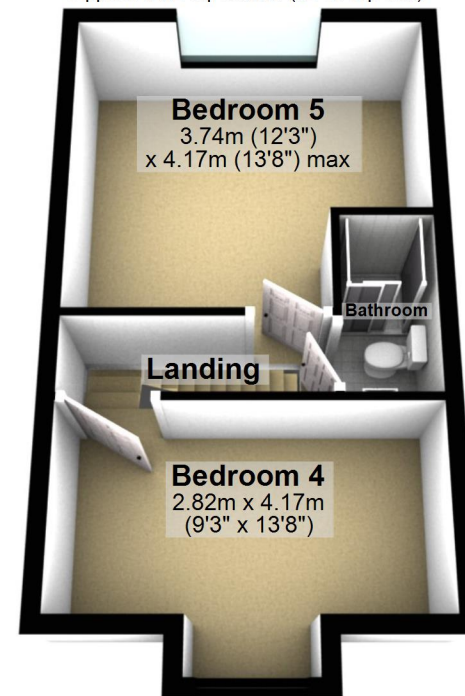

Total area: approx. 102.7 sq. metres (1105.3 sq. feet)